

2017 Winter Camp Information

Before Camp Begins:

- Please register [online](#), in person, or by phone at 877.946.7797. **Registration must be completed before your child can participate.**
- Camps are held in learning labs at the San Diego Natural History Museum, which is located at 1788 El Prado, Balboa Park, San Diego, CA 92101 (map below).
- Our winter camps are organized by your child's current grade level. To ensure a high-quality experience, it is important that all participants are with their same-aged peers (grades 1-2 or 3-5).

Parking:

- Parking is free in Balboa Park, but can be difficult around the holidays. Please allow ample time to find a parking space for drop off, and remember to lock your vehicle.

Check In and Pick Up:

- To check in, please walk your child into the Museum via the north entrance (by the giant fig tree) 10-15 minutes prior to the start of camp and check in at the classroom. You will have the opportunity to meet the camp instructor.
- Pick up your child at the south end of the parking lot on the east side of the Museum (the end closest to the fountain in the lot directly to your left when you turn onto Village Place from Park Boulevard). You can pull up to the curb and do not need to find parking. Please pull up as far as you are able to along the curb, to allow for a smooth flow of traffic. Exit your vehicle and sign your child out at the table. Refer to the maps included below.
- Photo IDs are required at pick up each day. Please be sure to list the person(s) picking up your child upon registration. Please list them as their name appears on their ID. Your child will not be released to persons you have not listed.
- Please be prompt in dropping off and picking up your child.
 - The Museum doors are locked 10 minutes after camp starts each day.
 - If you are running late or will be absent, please call Customer Service at 877.946.7797.
 - If you are more than 15 minutes late for pick up, a \$10 late fee will apply.

All Camps:

- All campers break for lunch and a snack. Lunches and snacks are not provided. Please provide lunch, a snack, and a beverage for your child daily. Please write a name on his/her lunch bag and beverage container. **Note: Winter Camp at The Nat is nut-free.**
- Please list all allergies (especially food allergies) when you register your child for camp.
- Children should wear comfortable play clothes that can get dirty. Closed-toe shoes only.
- All camps will visit the Museum exhibitions and spend time out in the Park. We recommend hats, jackets, and sunscreen.
- For additional information, please refer to the FAQ.

Park Map:

For more detailed directions, visit [our website](#).

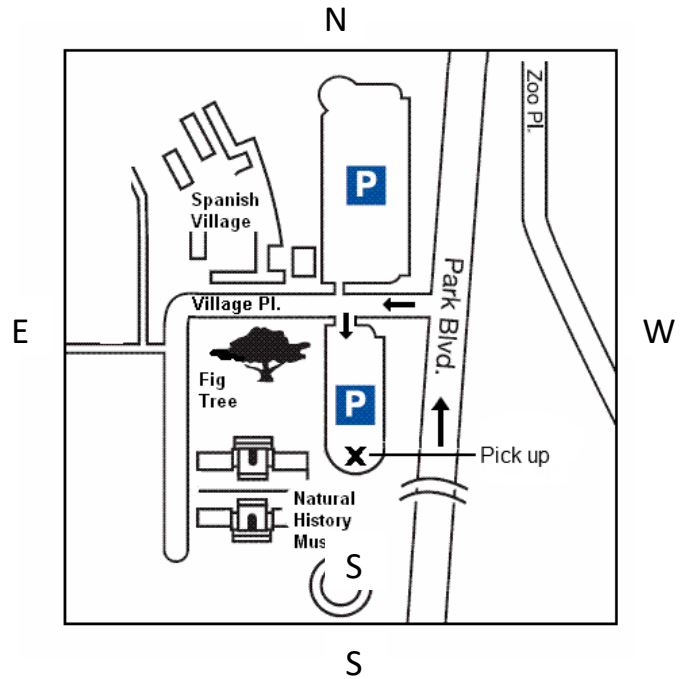

EDUCATION MAP
1st FLOOR

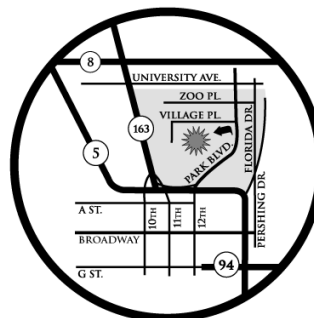
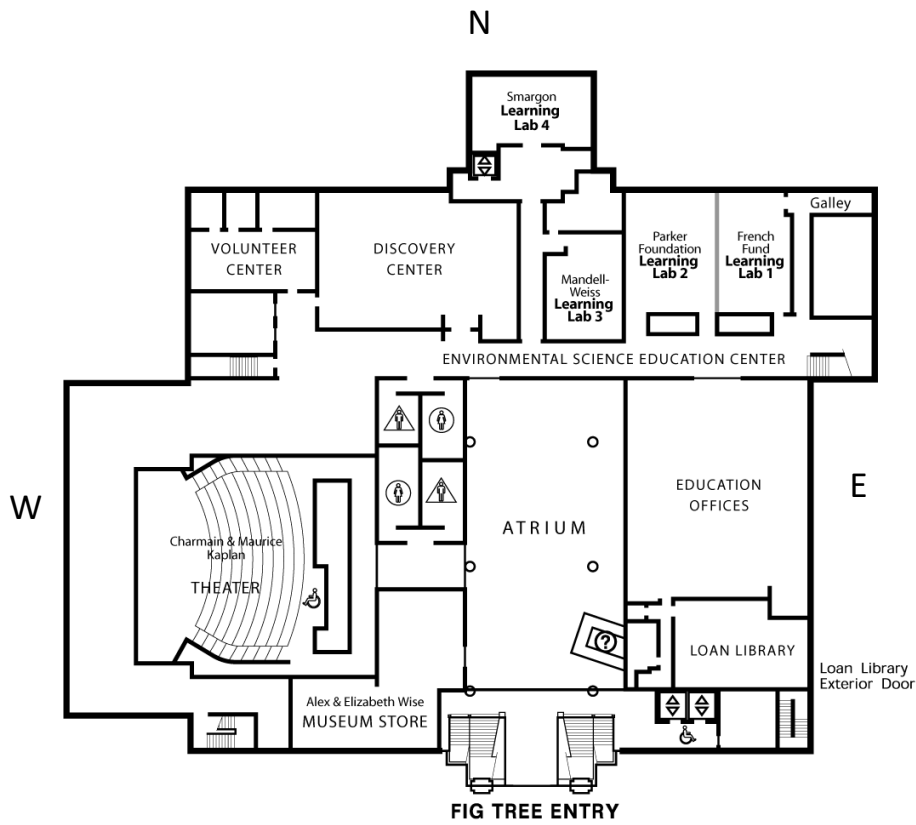

SAN DIEGO NATURAL HISTORY MUSEUM
1788 El Prado, San Diego, CA 92101