



## 2013 Summer Camp Information

### Before Camp Begins:

- Return the **Camper Release Form** and the **Camper Emergency Release Form** at least **one month prior to the camp by mail** to:  
SDNHM/ Education Department  
PO Box 121390  
San Diego, CA 92112  
**Or by fax to 619.235.9446**
- Camps are held in the Learning Labs at the San Diego Natural History Museum located at 1501 Village Place, San Diego, CA 92101 in Balboa Park (map attached below).
- Our camps are designed by grade level. Children in Preschool-Kindergarten classes must be four years old at the start of camp and/or entering Kindergarten. Children in classes for grades 1–5 should enroll in camps based on their grade level as of September 2013. To ensure a high quality experience it is important that all participants are with their same age peers.

### The First Day of Camp:

- Parking is free in Balboa Park. Parking can be difficult, particularly in the afternoon. Please allow sufficient time to find a parking space for the first day of camp. Remember to lock your vehicle
- Please walk your child into the Museum via the North Entrance (fig tree) 15 minutes prior to the start of camp and check in at the registration table. You will have the opportunity to meet the camp instructor, camp assistant, and camp aides and visit the classroom.

### During Camp:

- All camps take a break for a snack. Snacks are not provided. Please bring a snack and a drink.
- Bring a sack lunch, in addition to snack, if your child is collaborating with another museum.
- **Please note all allergies (especially food allergies) on the Emergency Release Form.**
- Children should wear comfortable play clothes that can get dirty. **Closed-toe shoes—NO sandals.**
- All camps will visit the Museum exhibitions and spend time out in the Park. We recommend hats and sunscreen.

### Dropping Off and Picking Up Your Child:

- **After your first check-in**, please drop-off/pick-up your child at the south end of the parking lot on the east side of the Museum. Pull your vehicle up to the turnout by the summer camp tent.
- The person picking up your child will be required to show a photo ID each day at pick-up. Please be sure that the name listed on your Camper Release Form matches the name on their license.
- **Please be prompt** in dropping off and picking up your child.
- **If you are running late or if your child will not be attending camp (illness, prior engagement, etc)**, please notify the Museum by calling 619.255.0210 or 877.946.7797. If you arrive later than 10 minutes after the program starts/ends, please plan to park and report to the North Admissions Desk to drop off or pick up your child. Staff will remain outside at the tent 10 minutes into the camp and at the end of the program.  
**Note: If you are more than 15 minutes late for pick-up, a \$10 late fee will be assessed.**
- If you need to pick up your child early, please notify your instructor at drop off or call the Education Department at 619.255.0210 and we will make arrangements to have your child ready for pick up. Please enter at the North Entrance and check in with the Admissions Desk.

## PARK MAP

For more detailed directions, visit  
<http://www.sdnhm.org/visit/directions.html>

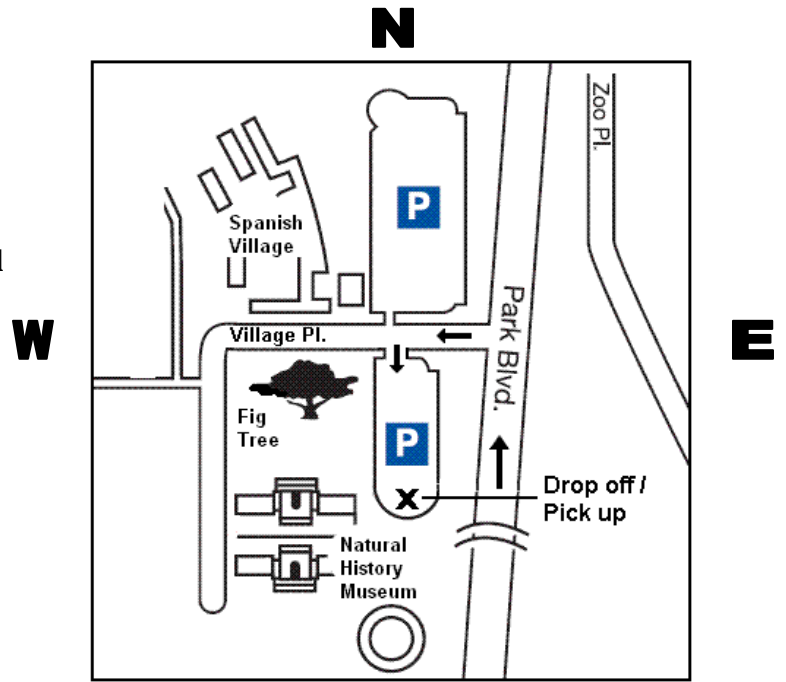

## EDUCATION MAP 1st FLOOR

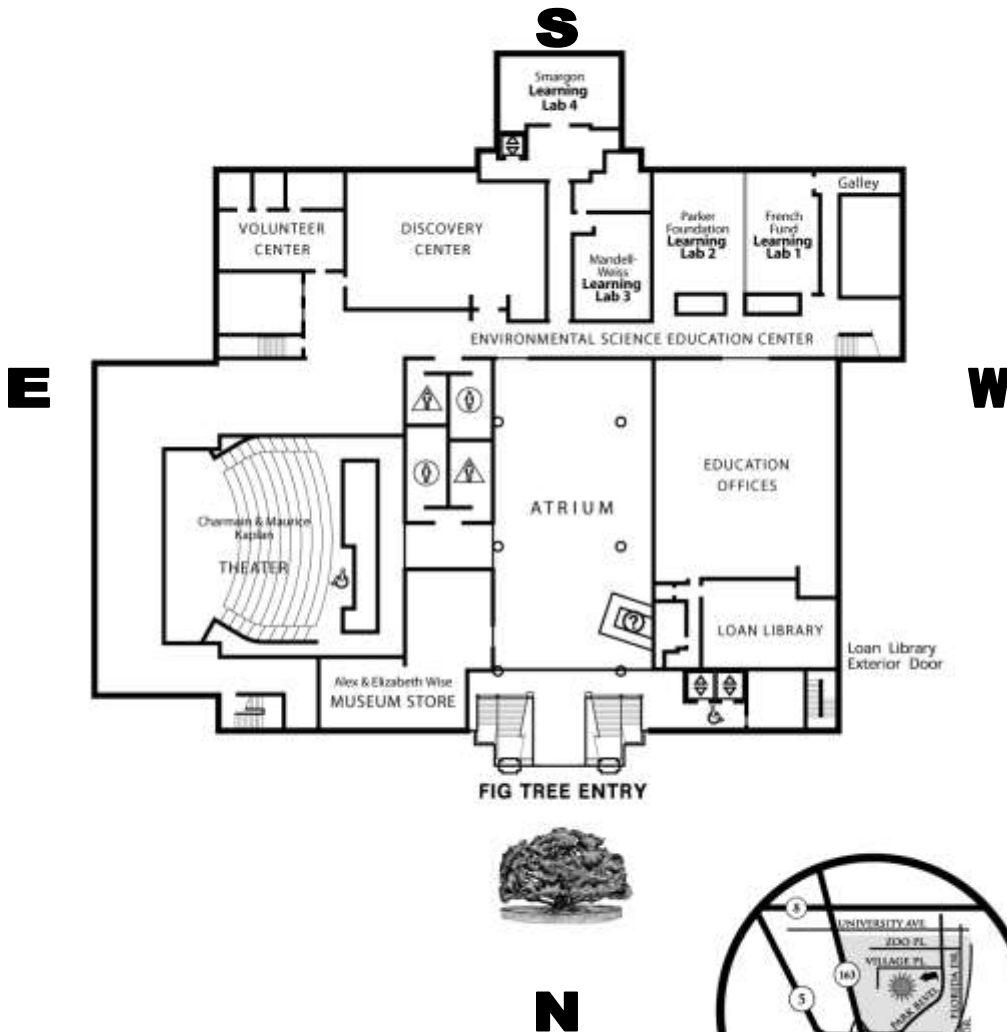

SAN DIEGO NATURAL HISTORY MUSEUM  
 1788 El Prado, San Diego, CA 92101